

**Specifications 625 Series**

**Features:**

- \*Single mold block
- \*2 pins per pole for stability
- \*Angled wire entry for easy access
- \*2 to 7 poles single mold/ Side stackable
- \*Push button lever

**Electrical**

Current: 12A @ 300V  
 Wire range: 16 to 22 Sol  
 Wire range: 16 to 20 Str  
 Wire section(mm<sup>2</sup>): 0.3 to 1.5mm<sup>2</sup>  
 Pin dimension: 0.95mm x 0.5mm  
 Operating temp: -40°C to +105°C  
 Stripping length: 10mm  
 PCB holes: min 1.3mm  
 PCB thickness: max 2.2mm

**Materials**

Housing: Polyamide 6,6  
 Contact spring: Stainless steel  
 Terminal pins: Brass, silver and tin plated  
 Colors available: Green (orange lever)

**Specifications 675 Dual Series**

**Features:**

- \*Accepts 2 wires per position (common)
- \*Available in several colors for coding positions to wire colors
- \*Available with or without push button
- \*1 position modular blocks
- \*2 pins per pole for stability

**Electrical**

Current: 10A @ 300V  
 Wire range: 18 to 24 Sol  
 Wire range: 18 to 20 Str  
 Wire section(mm<sup>2</sup>): 2 x 0.25 to 0.75mm<sup>2</sup>  
 Pin dimension: 0.8mm x 0.5mm  
 Dielectric strength: 4kV  
 IR: >5MΩ (500V DC)  
 Operating temp: -40°C to +105°C  
 Stripping length: 9mm  
 PCB holes: min 1.1mm  
 PCB thickness: max 2.4mm

**Materials**

Housing/button: Polyamide 6,6 (UL94V-0)  
 Contact spring: Stainless steel  
 Terminal pins: Brass, silver and tin plated  
 Colors available: Gray (standard), for others see how to order

12A 300V

5.08mm

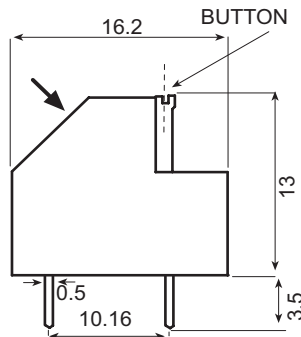
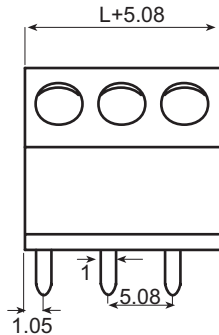
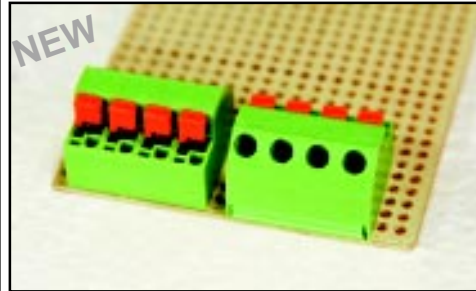

PCB Layout

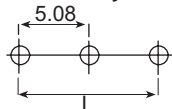

**Dimensions**

n=number of poles  
 L=(n-1) x 5.08

**Ordering Information**

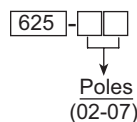

10A 300V

5mm

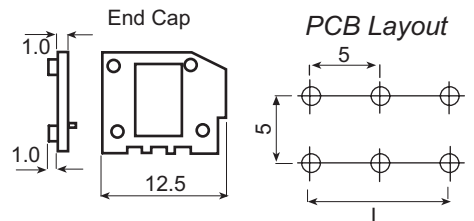
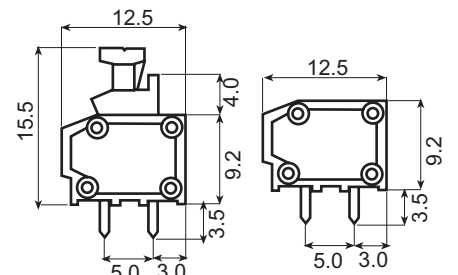
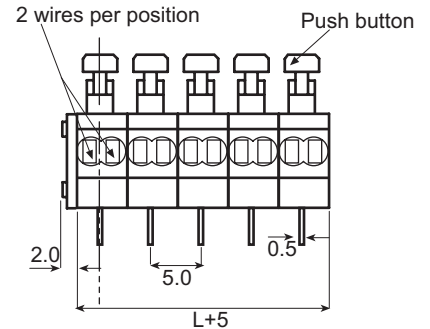

**Dimensions**

n=number of poles  
 L=(n-1) x 5

**Ordering Information**

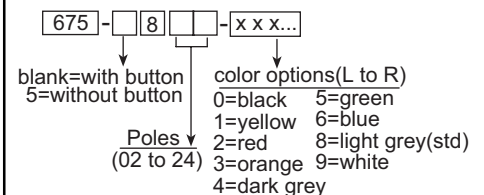

Also available in 7.5mm and 10mm centers.