

12A 300V

5 and 5.08mm

Specifications: CIM-E Series

Features:

- *CIM Ejector headers for use with CIF and CVF plugs
- *The Ejector eases removal of longer position plugs or plugs in difficult to reach places
- *Safer than pulling directly on the plug
- *Operated by pressing both red Ejector levers simultaneously
- *2 to 21 positions single mold (5/5.08)
- *2 Styles available (see chart)
- *Key coding capable
- *Housing is resistant to chlorinated solvents, with no dioxin or detrimental to health halogens
- *Every position of this product is mechanically and electrically tested during assembly to ensure a 100% defect free product
- *Minimum 5 microns of tin plating on terminal for easy soldering

Electrical

- Current(5/5.08): 12A @ 300V
- Pin dimension: 1mm x 1mm
- CR: <15mΩ
- IR: >10⁹ Ω (500V DC)
- Operating temp: -40°C to +110°C
- PCB holes: min 1.4mm
- PCB thickness: max 2.4mm
- Climactic category: 40/110/21 Acc. to IEC 68-1
- Insertion force: max 3 N
- Disconnecting force: min 1.5 N

Materials

- Housing: Polyamide 6,6 (UL94V-0)
- Terminal pin: Bronze, Tin plated
- Colors available: Green is standard
Black is optional

Marking

Consult factory for marking options.

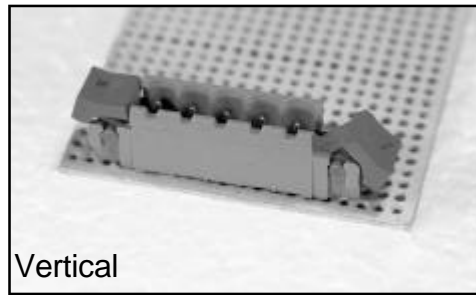

Vertical

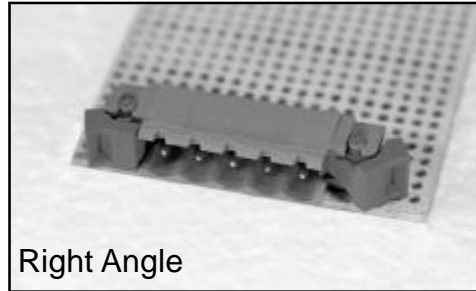

Right Angle



Style	Front	Side
0E ejector end vertical		
9E ejector end right angle		

PCB Layout

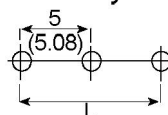

Ordering Information
5 and 5.08

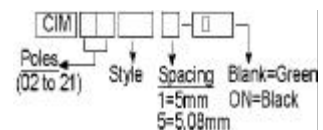

Dimensions

n=number of poles
 L=(n-1) x 5 (for 5mm spacing)
 L=(n-1) x 5.08 (for 5.08mm spacing)
 Also available in 10mm and 10.16mm centers.