

Specifications: **CIM Series**

Features:

- \*CIM headers for use with CIF and CVF plugs
- \*2 to 25 positions single mold (5/5.08)
- \*2 to 12 positions single mold (7.5/7.62)
- \*4 Styles available (see chart)
- \*Key coding capable
- \*Housing is resistant to chlorinated solvents, with no dioxin or detrimental to health halogens.
- \*Every position of this product is mechanically and electrically tested during assembly to ensure a 100% defect free product.
- \*Minimum 5 microns of tin plating on terminal for easy soldering.

Electrical

- Current(5/5.08): 15A @ 300V
- Current(7.5/7.62): 15A @ 450V
- Pin dimension: 1mm x 1mm
- CR: <15mΩ
- IR: >10<sup>9</sup>Ω (500V DC)
- Operating temp: -40°C to +110°C
- PCB holes: min 1.4mm
- PCB thickness: max 2.4mm
- Climactic category: 40/110/21 Acc. to IEC 68-1
- Insertion force: max 3 N
- Disconnecting force: min 1.5 N

Materials

- Housing: Polyamide 6,6 (UL94V-0)
- Terminal pin: Bronze, Tin plated
- Colors available: Green

Marking

Consult factory for marking options.

15A 300V 5 and 5.08mm

15A 450V 7.5 and 7.62mm

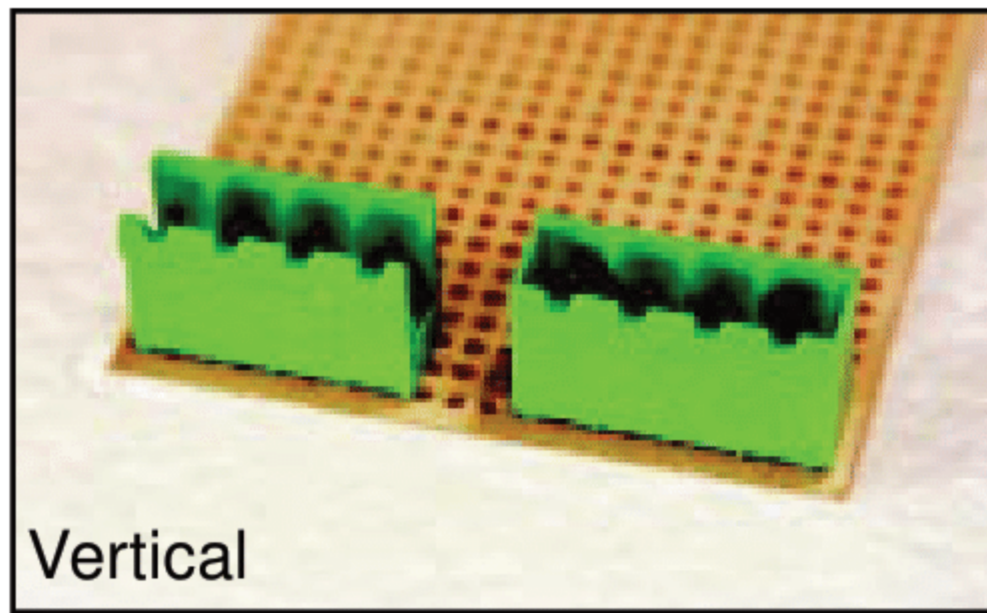

Vertical

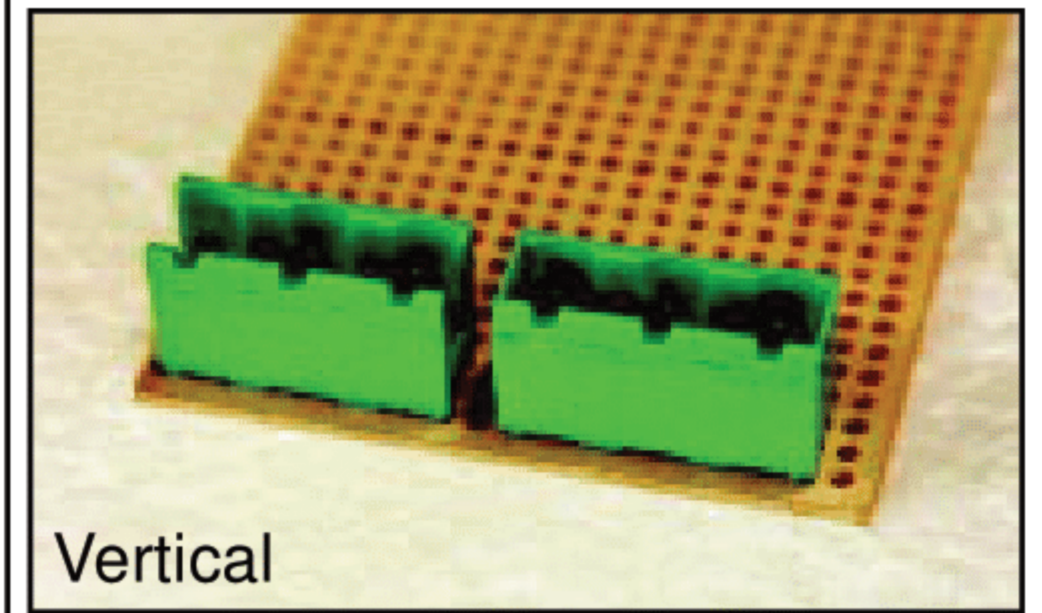

Vertical

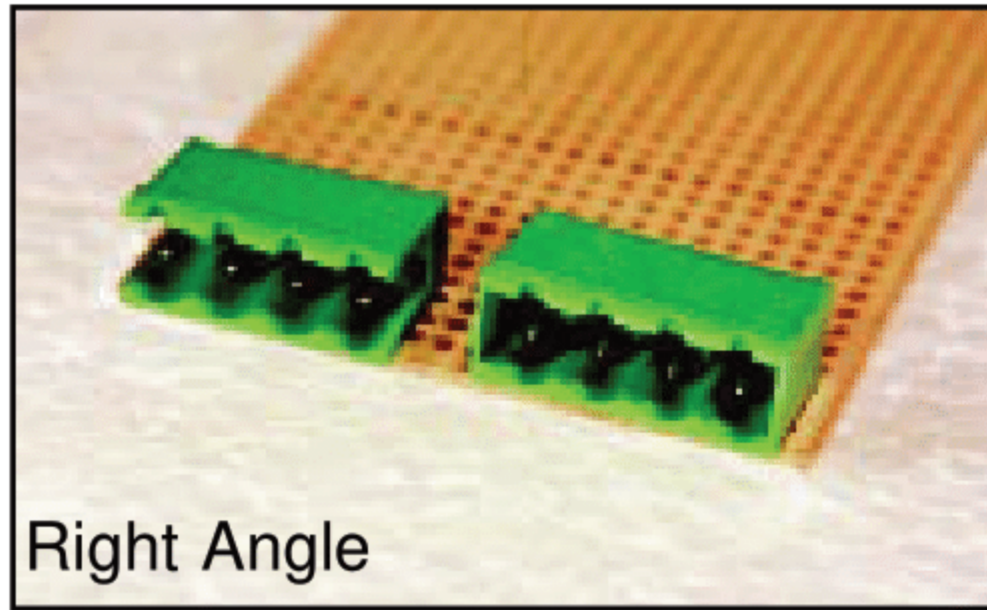

Right Angle

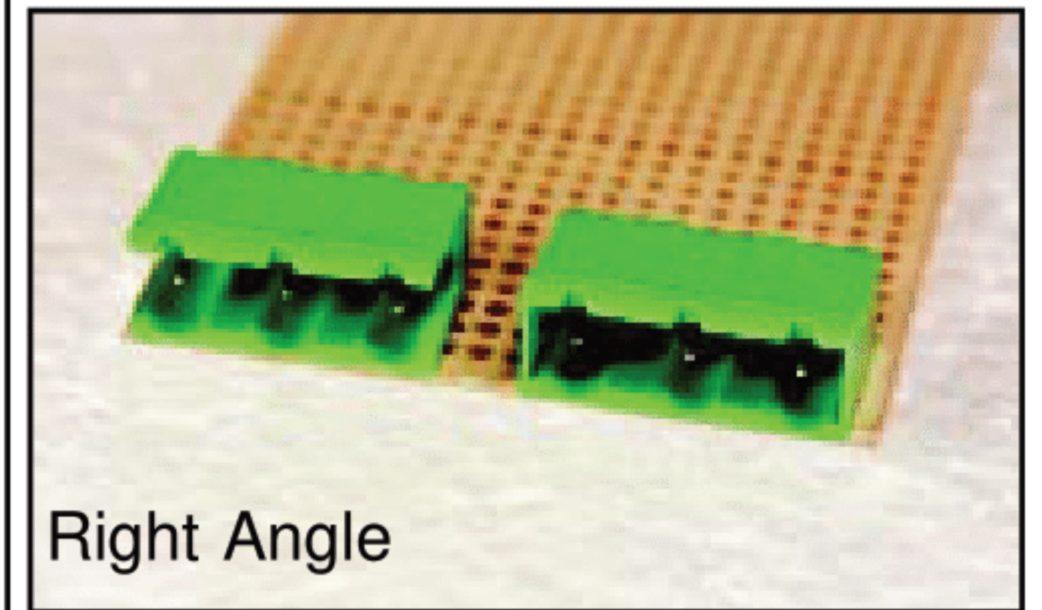

Right Angle



Style	Front	Side
<b>0P</b> closed end vertical		
<b>0A</b> open end vertical		
<b>9P</b> closed end right angle		
<b>9A</b> open end right angle		

Style	Front	Side
<b>0P</b> closed end vertical		
<b>0A</b> open end vertical		
<b>9P</b> closed end right angle		
<b>9A</b> open end right angle		

PCB Layout

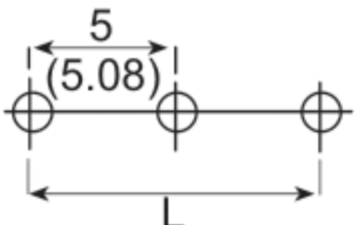

PCB Layout

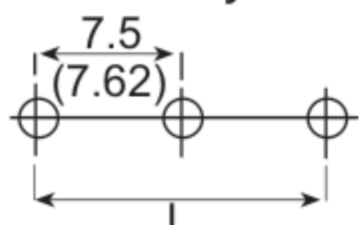

Ordering Information

5 and 5.08

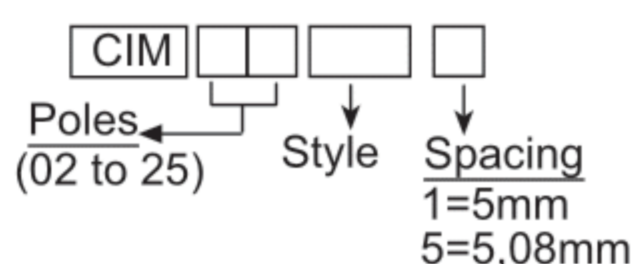

7.5 and 7.62

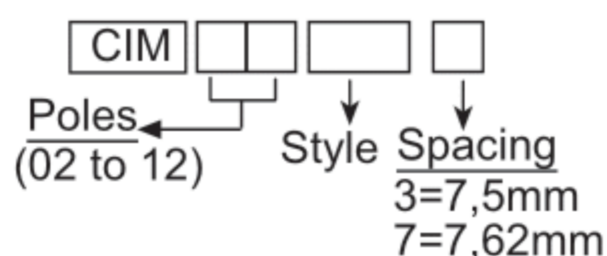

Dimensions

n=number of poles  
 L=(n-1) x 5 (for 5mm spacing)  
 L=(n-1) x 5.08 (for 5.08mm spacing)  
 Also available in 10mm and 10.16mm centers.

Dimensions

n=number of poles  
 L=(n-1) x 7.5 (for 7.5mm spacing)  
 L=(n-1) x 7.62 (for 7.62mm spacing)